









PATHWAY





**From:** Abbey McMillan-8771  
**Sent:** Thursday, 2 May 2019 12:30 PM  
**To:** 'Ross Davis'  
**Cc:** cablebayrocks@orcon.net.nz  
**Subject:** Re: 26447 Heeman U170593  
**Attachments:** 26447 Sketch.pdf; 26447 Condition survey 2017-11-17.pdf; DSC\_0076.JPG; 26447 Heeman Report.pdf; foreshore structures supporting information\_updated Draft.rtf; boatshed Okiwa bay

Good afternoon,

The following information, in red, is still missing:

### **Resource Consent Application U170593**

Please provide the following:

1. A new Engineer's Inspection Report – *Ross Davis I understand was to do this for you? I note that the inspection report was dated 2017 and the works to be carried out within 1 year have not yet been undertaken which is 18months overdue.*

The application must include a recent inspection report from a Chartered Professional Engineer having experience in marine structures. The inspection report should address the following matters:

- a) Describe all remedial work that is required to bring the structure(s) into a structurally sound and fit-for-purpose condition, together with a time period(s) in which the work should be carried out; or
- b) Confirm that the existing structure is sound, fit for purpose and that no remedial work is required; and
- c) Describe any particular maintenance work required to ensure that the structure remains structurally sound and fit for purpose during the term of the new resource consent.

It is the applicant's responsibility to arrange an inspection by a Chartered Professional Engineer – Council does not have a list of approved or accredited engineers.

2. Site Plan showing dimensions of the boatshed, slipway [Engineer can include this in Report] **and boat if it is to remain.**
3. **Assessment of the relevant objectives, policies and rules in the Marlborough Sounds Resource Management Plan. At minimum, please fill out the attached form.**
4. **Internal photos of the boatshed including any ablution facilities such as shower, wash basin, toilet.**

Please provide answers the following queries:

5. Please outline in further detail how the boatshed is used such as; **what is currently stored in the boatshed [only materials and tools for boat maintenance?]**? How often is the boatshed used? What recreational activities are carried out in/around the boatshed?
6. **It does not appear that you own land or reside in Okiwa Bay or Anakiwa. Please outline your association with the bay.**
7. Are you seeking resource consent to permanently store your catamaran adjacent to the boatshed and slipway? If not, how often is the vessel proposed to be located there? Is the vessel sea worthy? **What kind of maintenance and modifications do you intend to carry out on the cat in this location [building, painting?]**?

The application will be publicly notified and the above missing information is still required.

Kind Regards,  
**Abbey McMillan**  
Resource Management Officer



Phone: 03 520 7400  
15 Seymour Street, PO Box 443  
Blenheim 7240, New Zealand  
[abbey.mcmillan@marlborough.govt.nz](mailto:abbey.mcmillan@marlborough.govt.nz)  
[www.marlborough.govt.nz](http://www.marlborough.govt.nz)

---

**From:** Ross Davis [mailto:Ross@davidsongroup.co.nz]  
**Sent:** Thursday, 2 May 2019 7:55 AM  
**To:** Abbey McMillan-8771  
**Cc:** cablebayrocks@orcon.net.nz  
**Subject:** 26447 Heenan U170593

Good morning Abbey

Please see attached

- Inspection Report
- Condition Survey
- Plan
- Photograph at a very low tide

There are a number of recommended remedial work items, simple work that will readily reinstate the structures for the future.

Our previous discussion indicated this application may proceed to public notification - will that be the case?

Thankyou and regards

Ross Davis  
Principal  
Davidson Group Ltd

**From:** Abbey McMillan-8771  
**Sent:** Wednesday, 1 May 2019 11:43 AM  
**To:** 'Ross Davis'; cablebayrocks@orcon.net.nz  
**Subject:** RE: urgent - Resource Consent Application - U170593 - Further information required  
**Importance:** High

Good morning,

Please see emails below, in particular, email sent by myself to Darren, copying in Ross, on 15 January 2019.



Will the below information be provided today?

Kind Regards,  
**Abbey McMillan**  
Resource Management Officer



Phone: 03 520 7400  
15 Seymour Street, PO Box 443  
Blenheim 7240, New Zealand  
[abbey.mcmillan@marlborough.govt.nz](mailto:abbey.mcmillan@marlborough.govt.nz)  
[www.marlborough.govt.nz](http://www.marlborough.govt.nz)

**From:** Ross Davis [mailto:Ross@davidsongroup.co.nz]  
**Sent:** Tuesday, 15 January 2019 5:13 PM  
**To:** Abbey McMillan-8771; cablebayrocks@orcon.net.nz  
**Subject:** RE: Resource Consent Application - U170593 - Further information required

Hello Abbey and Darren

Darren – we have looked at this and I will be in touch soon, apologies for the long delay.

Thank you and regards

Ross Davis  
DDI 03 577 1923



**From:** Abbey McMillan-8771  
**Sent:** Tuesday, January 15, 2019 5:11 PM  
**To:** cablebayrocks@orcon.net.nz  
**Cc:** Ross Davis  
**Subject:** RE: Resource Consent Application - U170593 - Further information required  
**Importance:** High

Good afternoon Darren,

### **Resource Consent Application U170593**

Please provide the following:

2. A new Engineer's Inspection Report – *Ross Davis I understand was to do this for you?*  
The application must include a recent inspection report from a Chartered Professional Engineer having experience in marine structures. The inspection report should address the following matters:
  - a) Describe all remedial work that is required to bring the structure(s) into a structurally sound and fit-for-purpose condition, together with a time period(s) in which the work should be carried out; or
  - b) Confirm that the existing structure is sound, fit for purpose and that no remedial work is required; and
  - c) Describe any particular maintenance work required to ensure that the structure remains structurally sound and fit for purpose during the term of the new resource consent.

It is the applicant's responsibility to arrange an inspection by a Chartered Professional Engineer – Council does not have a list of approved or accredited engineers.

5. Site Plan showing dimensions of the boatshed, slipway [Engineer can include this in Report] and boat if it is to remain.
6. Assessment of the relevant objectives, policies and rules in the Marlborough Sounds Resource Management Plan. At minimum, please fill out the attached form.
7. Internal photos of the boatshed including any ablution facilities such as shower, wash basin, toilet.

Please provide answers the following queries:

8. Please outline in further detail how the boatshed is used such as; what is currently stored in the boatshed? How often is the boatshed used? What recreational activities are carried out in/around the boatshed?
9. It does not appear that you own land or reside in Okiwa Bay or Anakiwa. Please outline your association with the bay.
10. Are you seeking resource consent to permanently store your catamaran adjacent to the boatshed and slipway? If not, how often is the vessel proposed to be located there? Is the vessel sea worthy? What kind of maintenance and modifications do you intend to carry out on the cat in this location?

If all the above information is not provided by **1 May 2019** the application will come off hold and continue being processed by way of public notification.

Please respond to this email if you have any questions regarding providing the above information.

Kind Regards,  
**Abbey McMillan**  
Resource Management Officer



Phone: 03 520 7400  
15 Seymour Street, PO Box 443  
Blenheim 7240, New Zealand  
[abbey.mcmillan@marlborough.govt.nz](mailto:abbey.mcmillan@marlborough.govt.nz)  
[www.marlborough.govt.nz](http://www.marlborough.govt.nz)

**From:** Cloe Vining-8735  
**Sent:** Tuesday, 27 February 2018 11:38 a.m.  
**To:** Cloe Vining-8735; [cablebayrocks@orcon.net.nz](mailto:cablebayrocks@orcon.net.nz)  
**Cc:** Cloe Vining-8735  
**Subject:** RE: RE: Resource Consent Application - U170593 - Further information required

Hi Darren,

Further to my email below, I must advise you that I am leaving Council with my last day being tomorrow the 28th February.

Please provide all of the information I have requested below as soon as possible to Peter Johnson who will

be taking over the processing of your application. He can be contacted at [peter.johnson@marlborough.govt.nz](mailto:peter.johnson@marlborough.govt.nz). Please direct any further queries to him.

Your application will remain on hold whilst we await the remaining information that has been requested from you in my emails below, as well as the engineer's inspection report of the structures.

Kind regards,  
Cloe

-----Original Message-----

**From:** Cloe Vining-8735 [<mailto:Cloe.Vining@marlborough.govt.nz>];  
**Sent:** 2/21/2018 2:07:09 PM  
**To:** Cable Bay Rocks [<mailto:cablebayrocks@orcon.net.nz>];  
**Subject:** RE: Resource Consent Application - U170593 - Further information required

Hi Darren,

Thank you for providing your response.

Please send me through the internal photos of the boatshed ones you have taken them.

Ablution facilities are those used for toileting or washing such as a toilet, shower or hand basin. Does the boatshed contain any of these?

If your boat is to remain stationed next to your slipway then this will require resource consent as it is occupation of the coastal marine area. Jetties are to be used for the loading and unloading of goods and people rather than a long term parking spot for a vessel hence why you will require consent for the boat.

If the boat is to remain where it is then please let me know and I will add it to your resource consent application.

I look forward to hearing from you soon.

Kind regards,

Cloe

**Cloe Vining**

**Resource Management Officer**



Phone: 03 520 7400

15 Seymour Street, PO Box 443

Blenheim 7240, New Zealand

[cloe.vining@marlborough.govt.nz](mailto:cloe.vining@marlborough.govt.nz)

[www.marlborough.govt.nz](http://www.marlborough.govt.nz)

**From:** Cable Bay Rocks [<mailto:cablebayrocks@orcon.net.nz>]

**Sent:** Tuesday, 20 February 2018 10:39 a.m.

**To:** Cloe Vining-8735

**Subject:** Re: Resource Consent Application - U170593 - Further information required

cloe I will head down today and take photos of the inside of boatshed.also what is ablution facilities ,maybe give examples .Also do I need resource consent to have a boat next to my boatshed,it is tied to the slipway which is registered as a jetty .I will supply the emergency no.for reference .I do not use the boatshed for accommodation ,however I have shagged few girls there over the years but not recently.

The boatshed has a bbq stored there,fishing gear a bicycle ,paddle board and oars .It has a winch for pulling the boat cradle into the shed.I have guttering catching the water off the roof and small water tank so I can wash off the salt water if required.Also I have purchased a windsurfer for which I would like to store in the boatshed also.

In October I organized a structural engineer to assess the boatshed ,but had no conformation that an inspection had been done yet.

I am putting a new interior in the catamaran but have put on hold till the resource consent is granted as I need the boatshed to store tools and materials .I am also thinking about getting the power reconnected again or hooking up solar ,this will help keep batteries charged up for tools.

The boatshed also has lifejackets and wetweather gear permantly down there and once I get resource consent I would like to take my outboard motor back there for my dingy which is stored on the shore by the boatshed as one of the locals use it sometimes.

from darren

**From:** [Cloe Vining-8735](mailto:Cloe Vining-8735)

**Sent:** Wednesday, February 14, 2018 2:31 PM

**To:** [Cloe.Vining@marlborough.govt.nz](mailto:Cloe.Vining@marlborough.govt.nz) ; [cablebayrocks@orcon.net.nz](mailto:cablebayrocks@orcon.net.nz)

**Cc:** [Cloe Vining-8735](mailto:Cloe.Vining-8735)

**Subject:** RE: RE: Resource Consent Application - U170593 - Further information required

Hi Darren,

I am email with regards to your resource consent application U170593 for an existing boatshed in Okiwa Bay.

Please provide a response to my remaining queries from my earlier email dated 29 August 2017, as shown in the email below.

In particular the following questions:

- P- Please provide the plan dimensions of the boatshed and slipway.
- 3. - Please outline in further detail how the boatshed is used such as; what specifically is stored in the boatshed? How often is the boatshed used? What recreational activities are carried out in the boatshed? Is the boatshed used for accommodation purposes?
- 4. 6- Are you seeking resource consent to permanently store your catamaran adjacent to the boatshed and slipway? If not, how often is the vessel proposed to be located there? Is the vessel sea worthy? What kind of maintenance and modifications do you intend to carry out on the cat in this location?

In addition to the above, please also respond to the following queries:

- When using the boatshed, what ablution facilities are used?
- Please provide internal photos of the boatshed.

I look forward to hearing from you soon.

Kind regards,

Cloe

-----Original Message-----

**From:** Cloe Vining-8735 [<mailto:Cloe.Vining@marlborough.govt.nz>];

**Sent:** 9/1/2017 2:10:56 PM

**To:** Cable Bay Rocks [<mailto:cablebayrocks@orcon.net.nz>];

**Subject:** RE: Resource Consent Application - U170593 - Further information required

Hi Darren,

Thank you for your email. Your application will remain on hold to allow you sufficient time to obtain an engineer's report and to respond to the remaining queries in my initial email.

If you are having trouble seeking a suitable engineer, the four main firms that Council receive engineer's reports from are as follows:

- Davidson Group
- Smart Alliances
- Seng Engineering Consulting
- Shearwater Consulting

Please keep me updated with any progress you make.

Kind regards,

Cloe

**Cloe Vining**

**Resource Management Officer**



Phone: 03 520 7400

15 Seymour Street, PO Box 443

Blenheim 7240, New Zealand

[cloe.vining@marlborough.govt.nz](mailto:cloe.vining@marlborough.govt.nz)

[www.marlborough.govt.nz](http://www.marlborough.govt.nz)

**From:** Cable Bay Rocks [<mailto:cablebayrocks@orcon.net.nz>]  
**Sent:** Tuesday, 29 August 2017 10:58 p.m.  
**To:** Cloe Vining-8735  
**Subject:** Re: Resource Consent Application - U170593 - Further information required

hello Cloe I have been involved in a high court trial that has soaked up an enormous amount of time in the last month. I have yet to find an engineer that has experience in marine structures, but am waiting on response at this time from a boat engineer. Last resource consent renewal I used a structural engineer and that was accepted.

I will provide plan dimensions and other queries at the same time to make my application complete, thank you for your patience, I have stopped all activities till the resource consent is renewed but will obtain an inspection of the boatshed and slipway and measurement and submit a report by the end of September.

The catamaran is tied to the jetty/slipway and is secure. I am not using a mooring as you have claimed I have implied sorry if I have put this in my application.

The address that I put on the application was simply the one the power board use as a location for my power connection. 5 years ago they put my address as 261 Anakiwa Road. However when I bought the boatshed in the early 1990's my address was 26 Akiwa Road but I believe Akiwa Road got amalgamated with Anakiwa Rd but I never got informed of any changes maybe as I didn't have a letterbox as I live in Nelson and use 18 Marybank Road as my mail address. I have a jetty no. now for emergency location that I will put in with my application.

thank you Cloe from Darren Heeman

**From:** [Cloe Vining-8735](mailto:Cloe Vining-8735)  
**Sent:** Monday, August 07, 2017 12:16 PM  
**To:** <mailto:cablebayrocks@orcon.net.nz>  
**Subject:** Resource Consent Application - U170593 - Further information required

Good morning Darren,

I have received and undertaken an initial assessment of your application for resource consent for an existing boatshed and slipway in Okiwa Bay and have determined that there is some essential information missing and further information required.

Please provide the following:

## 1. A new Engineer's Inspection Report

The application must include a recent inspection report from a Chartered Professional Engineer having experience in marine structures. The inspection report should address the following matters:

- a) Describe all remedial work that is required to bring the structure(s) into a structurally sound and fit-for-purpose condition, together with a time period(s) in which the work should be carried out; or
- b) Confirm that the existing structure is sound, fit for purpose and that no remedial work is required; and
- c) Describe any particular maintenance work required to ensure that the structure remains structurally sound and fit for purpose during the term of the new resource consent.

It is the applicant's responsibility to arrange an inspection by a Chartered Professional Engineer – Council does not have a list of approved or accredited engineers.

Please respond to the following queries:

2. Please provide the plan dimensions of the boatshed and slipway.
3. Please outline in further detail how the boatshed is used such as; what specifically is stored in the boatshed? How often is the boatshed used? What recreational activities are carried out in the boatshed? Is the boatshed used for accommodation purposes?
4. The application implies that recreational vessels are stored on a mooring, what is the mooring number you are using?
5. It does not appear that you own land in Okiwa Bay yet the application states the address is 275 Anakiwa Road, which the ownership of is under a different name. Please outline your association with the bay.
6. Are you seeking resource consent to permanently store your catamaran adjacent to the boatshed and slipway? If not, how often is the vessel proposed to be located there? Is the vessel sea worthy? What kind of maintenance and modifications do you intend to carry out on the cat in this location?

Your application has been put on hold under section 92 of the RMA. Please respond to this email by Monday, 28<sup>th</sup> August advising when you expect to have the requested information by.

I look forward to your response.

Kind regards,

Cloe

**Cloe Vining**

**Resource Management Officer**





**MARLBOROUGH  
DISTRICT COUNCIL**



Phone: 03 520 7400

15 Seymour Street, PO Box 443

Blenheim 7240, New Zealand

[cloe.vining@marlborough.govt.nz](mailto:cloe.vining@marlborough.govt.nz)

[www.marlborough.govt.nz](http://www.marlborough.govt.nz)

---

This email, including any attachments, is confidential and may contain legally privileged material and is only for the use of the intended recipient. If you are not the intended recipient then any use, dissemination, distribution or copying of this message is strictly prohibited. If you have received this email in error please notify us immediately and delete the original message. This email does not necessarily represent the views of the Marlborough District Council. Thank you.

---

---

Virus-free. [www.avast.com](http://www.avast.com)

---

Virus-free. [www.avast.com](http://www.avast.com)

---

This e-mail message has been scanned by **SEG Cloud**

---

This e-mail message has been scanned by **SEG Cloud**

---



**RECORD OF TITLE  
UNDER LAND TRANSFER ACT 2017  
FREEHOLD  
Search Copy**



R. W. Muir  
Registrar-General  
of Land

**Identifier** **MB1C/639**  
**Land Registration District** **Marlborough**  
**Date Issued** 22 September 1966

**Prior References**  
MB1B/1462

---

**Estate** Fee Simple  
**Area** 1692 square metres more or less  
**Legal Description** Lot 10-11 Deposited Plan 3180

**Registered Owners**  
Paul Boulton

**Interests**

58679 Transfer creating the following easements

<b>Type</b>	<b>Servient Tenement</b>	<b>Easement Area</b>	<b>Dominant Tenement</b>	<b>Statutory Restriction</b>
Convey water	Section 3 Toms Grant - CT MB1C/1218	Yellow DP 3180	Lot 10-11 Deposited Plan 3180 - herein	

114071.6 Transfer creating the following easements - 1.6.1983 at 11.22 am

<b>Type</b>	<b>Servient Tenement</b>	<b>Easement Area</b>	<b>Dominant Tenement</b>	<b>Statutory Restriction</b>
Convey water	Lot 50 Deposited Plan 5387 - CT MB3E/610	1 DP 5387	Lot 10-11 Deposited Plan 3180 - herein	

Transfer surrendering the right to convey water created by Transfer 58679 over the part Lot 5 marked B on DP 5387 (pt CT MB3E/607) appurtenant to the within land

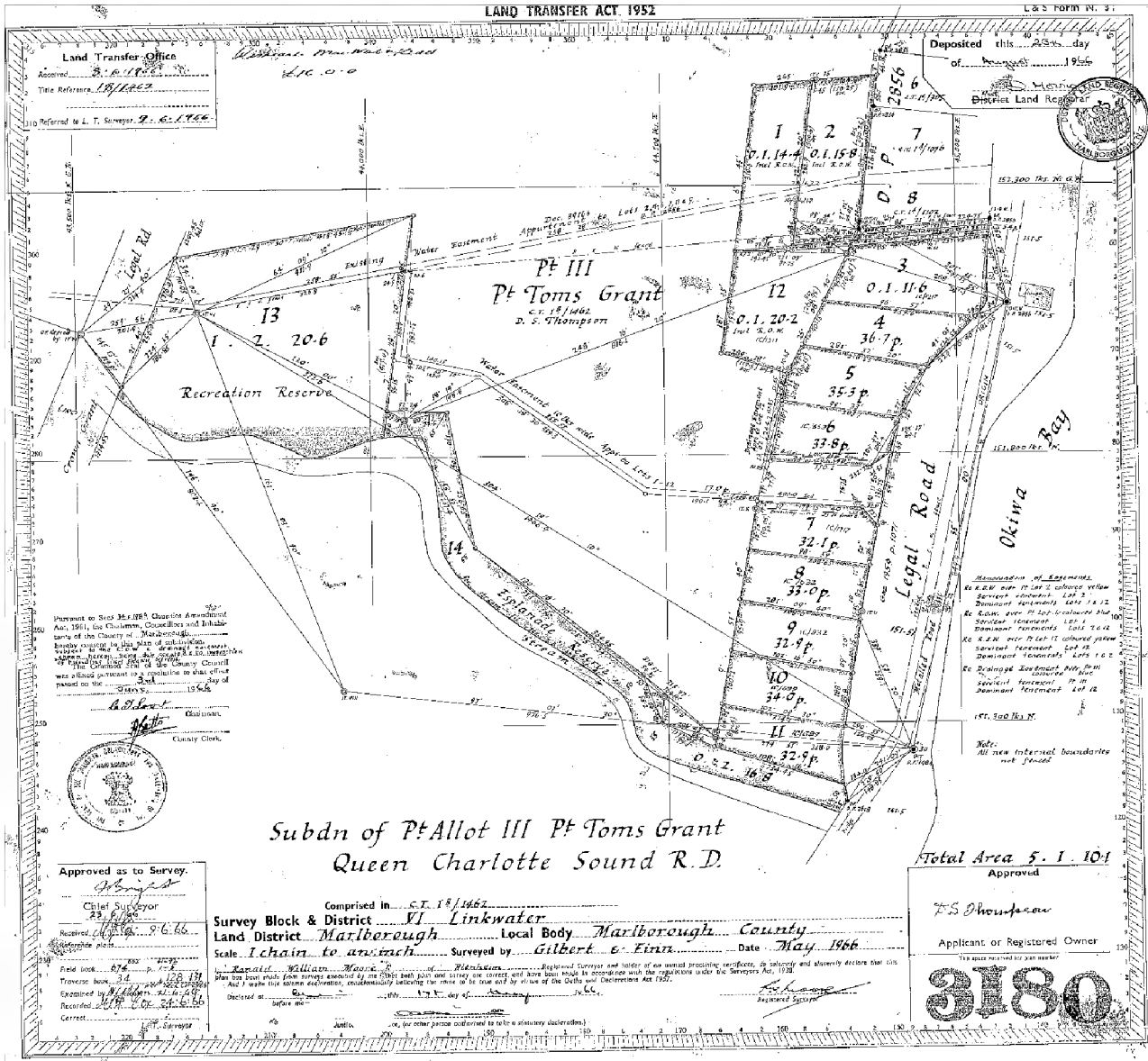

To: Marlborough District Council  
PO Box 443  
Blenheim 7240



ISO 9001:2008  
Document Number:  
RAF0010-C11921

## SUBMISSION ON APPLICATION FOR A RESOURCE CONSENT

### 1. Submitter Details

Name of Submitter(s) in full \_\_\_\_\_

Electronic Address for Service (*email address*) \_\_\_\_\_

Postal Address for Service (*or alternative method of service under section 352 of the Act*) \_\_\_\_\_

Primary Address for Service (*must tick one*)

Electronic Address (*email, as above*)

or, Postal Address (*as above*)

Telephone (*day*) \_\_\_\_\_ Mobile \_\_\_\_\_ Facsimile \_\_\_\_\_

Contact Person (*name and designation, if applicable*) \_\_\_\_\_

### 2. Application Details

Application Number \_\_\_\_\_ U \_\_\_\_\_

Name of Applicant (*state full name*) \_\_\_\_\_

Application Site Address \_\_\_\_\_

Description of Proposal \_\_\_\_\_

### 3. Submission Details (*please tick one*)

I/we support all or part of the application

I/we oppose all or part of the application

I/we are neutral to all or part of the application

- I am a trade competitor for the purposes of section 308B of the Resource Management Act 1991
- I am directly affected by an effect of the subject matter of the submission that:
  - a) adversely affects the environment; and
  - b) does not to relate to trade competition or the effects of trade competition
- I am NOT directly affected by an effect of the subject matter of the submission that:
  - a) adversely affects the environment; and
  - b) does not to relate to trade competition or the effects of trade competition
- I am NOT a trade competitor for the purposes of section 308B of the Resource Management Act 1991

The specific parts of the application that my/our submission relates to are *(give details, using additional pages if required)*

---



---



---

The reasons for my/our submission are *(use additional pages if required)*

---



---



---

The decision I/we would like the Council to make is *(give details including, if relevant, the parts of the application you wish to have amended and the general nature of any conditions sought. Use additional pages if required)*

---



---



---

**4. Heard in Support of Submission at the Hearing**

- I/we wish to speak in support of my/our submission
- I/we do not wish to speak in support of my/our submission

OPTIONAL: Pursuant to section 100A of the Resource Management Act 1991 I/we request that the Council delegate its functions, powers, and duties required to hear and decide the application to one or more hearings commissioners who are not members of the Council. *(Please note that if you make such a request you may be liable to meet or contribute to the costs of commissioner(s). Requests can also be made separately in writing no later than 5 working days after the close of submissions.)*

---

## 5. Signature

Signature \_\_\_\_\_ Date .....

Signature \_\_\_\_\_ Date \_\_\_\_\_

---

## 6. Important Information

- Council must receive this completed submission before the closing date and time for receiving submissions for this application. The completed submission may be emailed to [mdc@marlborough.govt.nz](mailto:mdc@marlborough.govt.nz).
- The closing date for serving submissions on the consent authority is the 20th working day after the date on which public or limited notification is given. If the application is subject to limited notification, the consent authority may adopt an earlier closing date for submissions once the consent authority receives responses from all affected persons.
- You must serve a copy of your submission on the applicant as soon as is reasonably practicable after you have served your submission on the consent authority.
- Only those submitters who indicate that they wish to speak at the hearing will be sent a copy of the section 42A hearing report.
- If you are making a submission to the Environmental Protection Authority, you should use form 16B.
- If you are a trade competitor, your right to make a submission may be limited by the trade competition provisions in Part 11A of the Resource Management Act 1991.
- If you make a request under section 100A of the Resource Management Act 1991, you must do so in writing no later than 5 working days after the close of submissions and you may be liable to meet or contribute to the costs of the hearings commissioner or commissioners. You may not make a request under section 100A of the Resource Management Act 1991 in relation to an application for a coastal permit to carry out an activity that a regional coastal plan describes as a restricted coastal activity.
- Please note that your submission (or part of your submission) may be struck out if the authority is satisfied that at least 1 of the following applies to the submission (or part of the submission):
  - it is frivolous or vexatious;
  - it discloses no reasonable or relevant case;
  - it would be an abuse of the hearing process to allow the submission (or the part) to be taken further;
  - it contains offensive language;
  - it is supported only by material that purports to be independent expert evidence, but has been prepared by a person who is not independent or who does not have sufficient specialised knowledge or skill to give expert advice on the matter.

---

## 7. Privacy Information

The information you have provided on this form is required so that your submission can be processed under the Resource Management Act 1991. The information will be stored on a public file held by Council. The details may also be available to the public on Council's website. If you wish to request access to, or correction of, your details, please contact Council.