

FLAXBOURNE MUSEUM AT WARD

Concept plan

February 2021

EXHIBITION
DESIGN
BUILD
CONSULTANCY
LTD



FLOORPLAN

Showing themed areas, cabinetry and plinths (marked by blue boxes). Grid pattern = 1 sqm

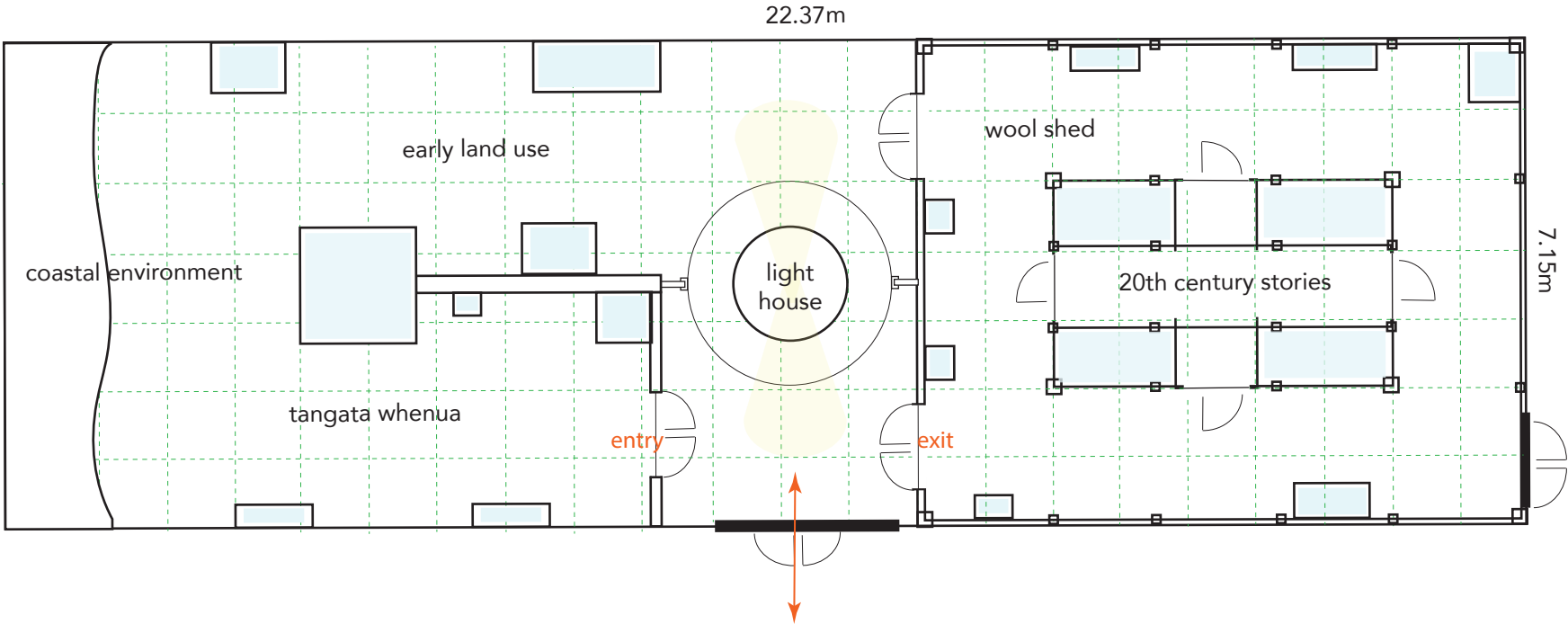

ENTRY ANNEX AREA

When the visitor enters the museum they are faced with a sensory experience. Directly in front is the lighthouse lens (open through to opposite side of museum), with a gently waxing and waning light emitting across the floor.

To the left is a waharoa gateway entrance with frosted glass doors and partially frosted glass walls.

Projected on to this surface is coastal waves and dunes.

To the right is a solid wall with exit doors, clad in a mix of weatherboard and corrugated iron to reference the woolshed.

Ambient sounds of surf, sheep and kouauau are heard here, and light levels are low.

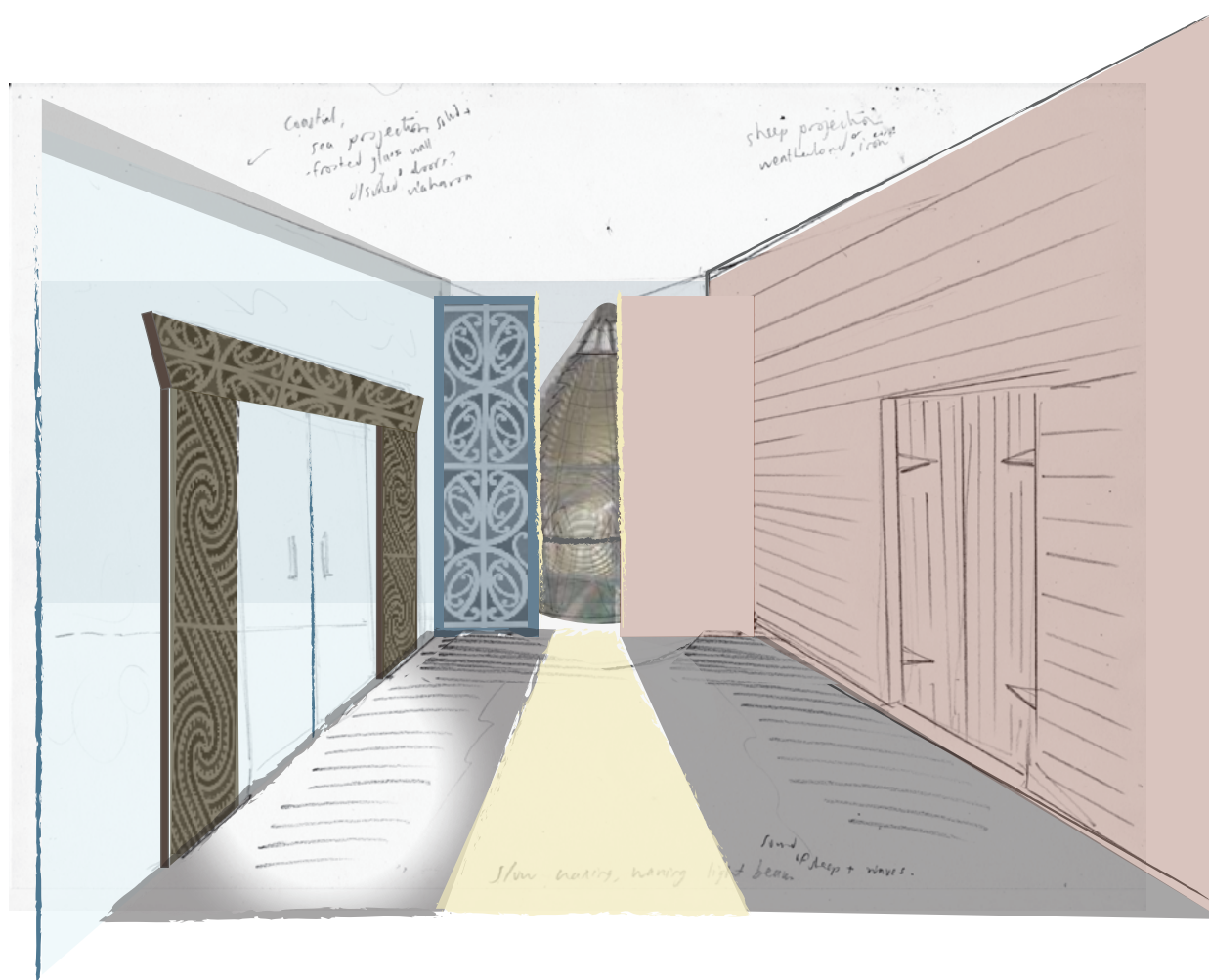
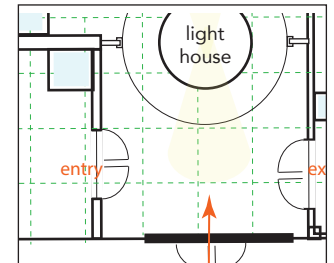

TANGATA WHENUA AREA

This area is yet to be developed in collaboration with local iwi. However, within the initial concept there is an allowance for secure cabinetry, and a cloak / textile / muka case (which will provide some environmental protection), audio, touchscreen and visual elements. A waharoa gateway, visible on both sides of entry point, is to be commissioned.

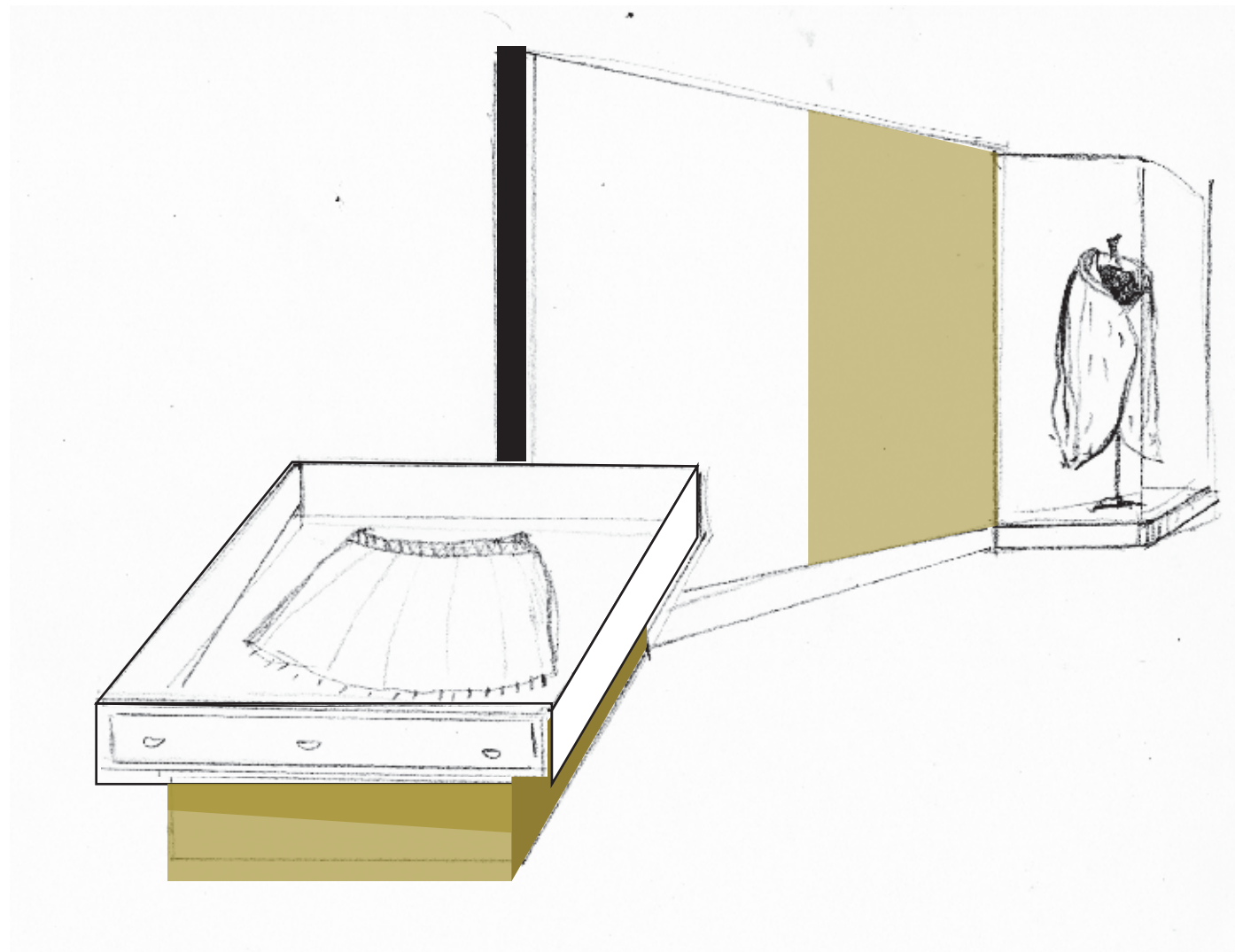
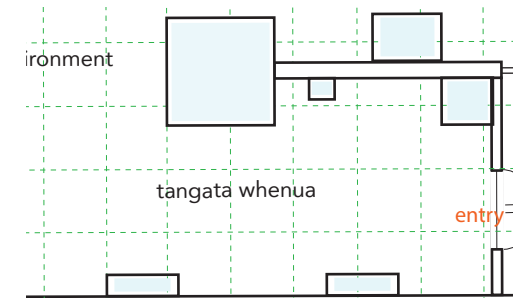

COASTAL AREA

The coastal area is situated in a big open space - sea and sky. The displays feature stories about the land and sea scape - from Māori history of formation through to the contemporary encounters with earthquakes and uplifts. There will be first hand audio accounts and recorded oral histories, as well as local art and interactive elements that help visitors understand the geological science of the region.

The base plinth has a defined coastline edge, recreated from a coastal map of the region.



Appropriate stories and objects will be placed along the platform. A barrier panel of perspex, or a set of interpretation panels will help deflect visitors from climbing into the display area here.

A replica rock showing height of uplift etc can house an interactive audio or visual unit.



EARLY LAND USE AREA

This area tells of the progressive efforts to tame the land, mainly focussing on the original farm station Flaxbourne. Some larger implements and ploughs will be on display here, along with the story of the transition from the station to a settlement in the early 1900s.

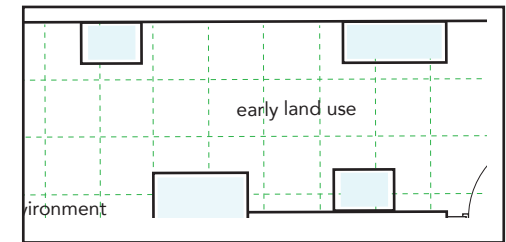
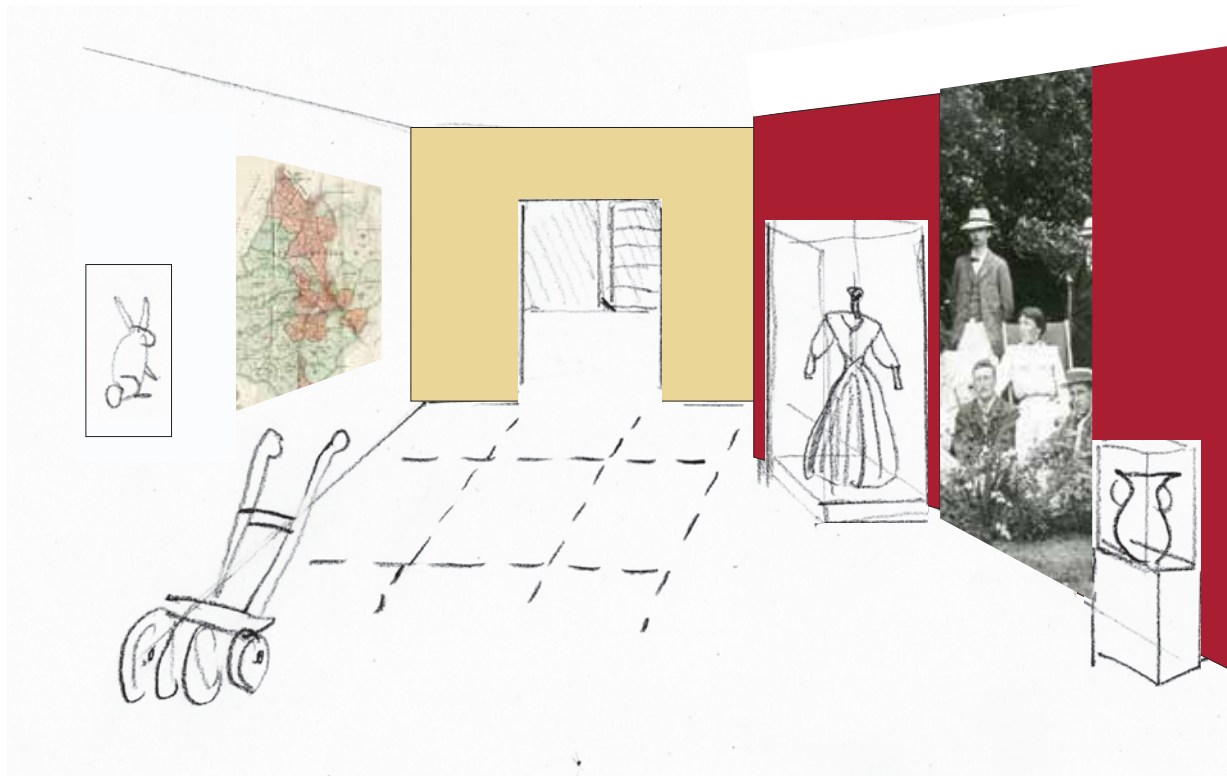

The right side of this area highlights the family life of Weld and Clifford families.

The left side, the dusty toil of farming the station.

On the floor near the exit point are divisions denoting the carving up of the estate into suburbia.

"The station, a wooden building in two wings, with a kind of veranda connecting them, painted white, with stables, sheep-yards, &c., stood about a quarter of a mile from the beach...."

At that time there were about 12,000 sheep on the run, which was the joint property of Weld and his cousin..Clifford...."

- Thomas Arnold, 1848

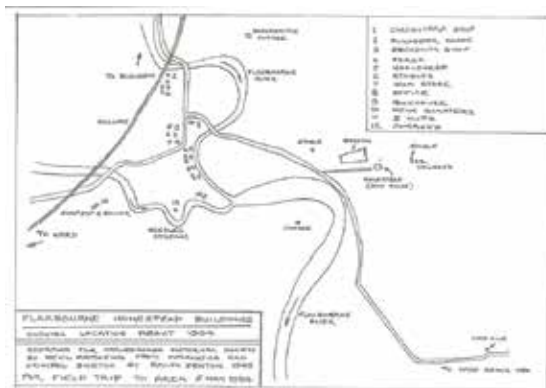

LIGHTHOUSE LENS ANNEX TO WOOLSHED AREA

This area features ship wrecks and other maritime related stories, and features the lighthouse story which the lens came from. A replica woolshed window frame provides opportunity for a lightbox interpretation / photographic images panel.

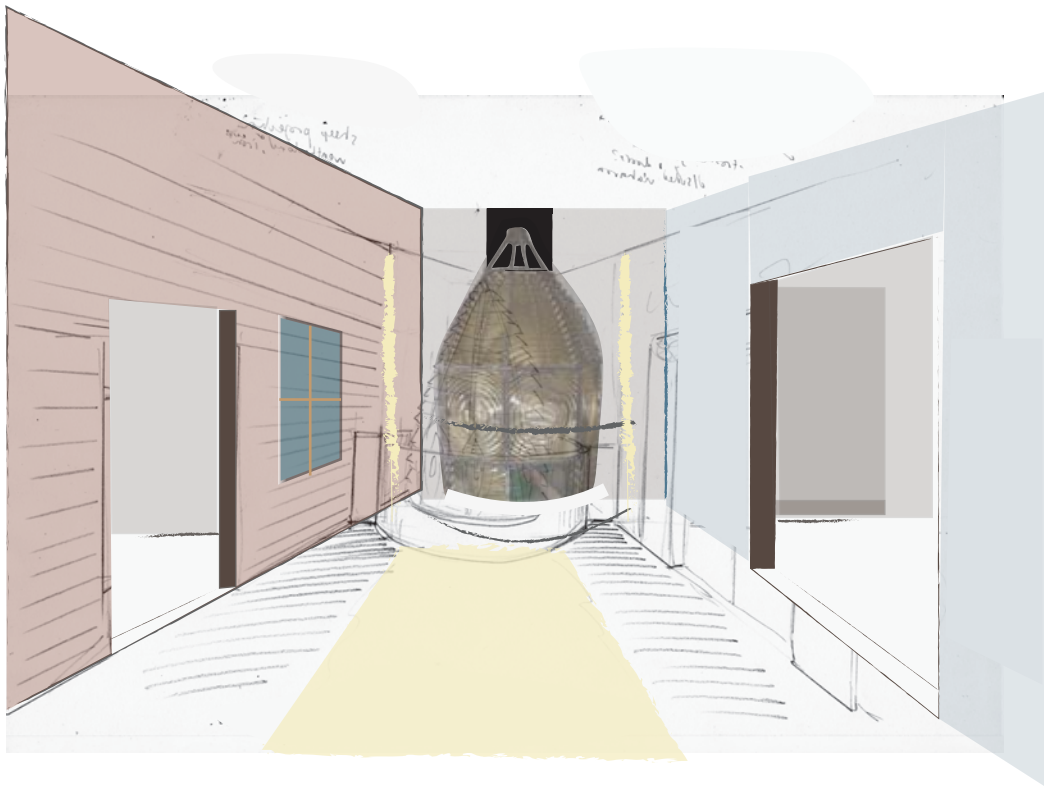
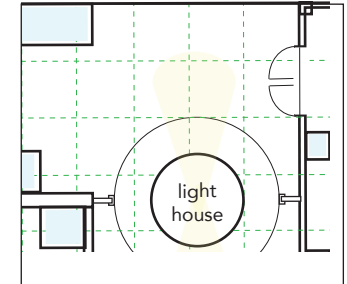

WOOLSHED AREA

The displays inside the woolshed area relate to 20th century development of the Ward / Flaxbourne area, and covers the region's social and industrial history, including the farming industry, rail, the effects of war on the community, local families, churches, and recreational aspects. The four central stalls of the wool shed have the appearance of original stalls, by using a facade of reclaimed materials. Their interiors are encased in glass to create a set of four changeable display cases. In between reclaimed wall studs will be interpretation panels, large images, and objects such as a wool classing table. Clusters of corralled sheep waiting to be shorn will be projected on a wall, along with ambient noise.

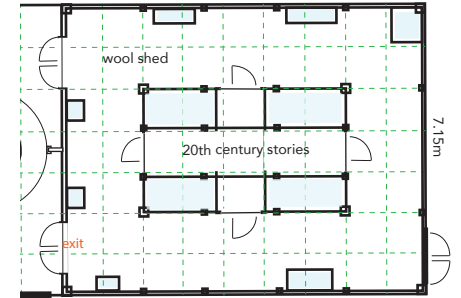

Reclaimed ceiling trusses will be installed, along with pens, stall gates and replica hatches, using reclaimed materials wherever possible.

