

Herb Thompson

2 May 2023

**Quote No: 23959-A**

Cell: 027 890 1353

Shed Location: 24 Ward Street, Ward, 7285

**ESTIMATE FOR:**

**LEAN-TO ADDITION, 5.0M X 24.0M LONG.**

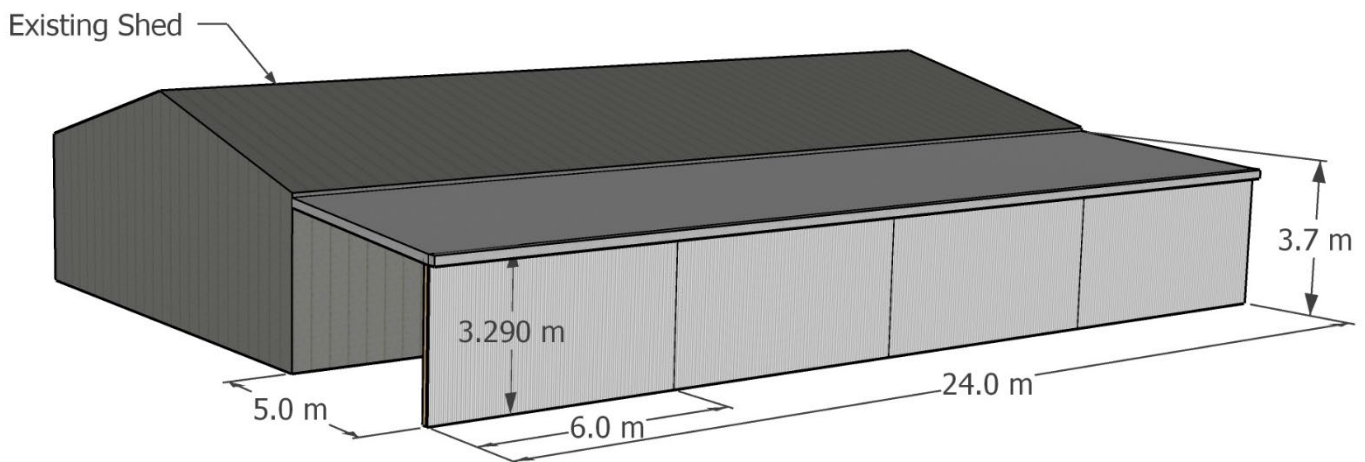

**Specifications:**

- Attaching to an existing Alpine shed.
- 4 Bays at 6.0m wide, open at one lean-to end only.
- Height of 3.290m up to 3.7m where it attaches to the existing shed.
- 0.55 Gauge Coloursteel corrugated on the roof and 0.4 Gauge Coloursteel 5-Rib on the walls.
- Includes barge flashings, providing you with a very tidy finish.
- Timber purlins are in joist hangers between timber beams.
- Guttering to be used from the existing building.
- Poles are H5 treated, and all timber is H3.2 tanilised, giving you long term peace of mind.
- Timber purlins and girts.
- Alpine get a 50-year Building Consent for you, council charge is not included.

**Estimate Kitset** \$25,940.00 + GST.

**Price: Delivery:** FREE – Provided you have forks to unload.

**Note:** I look forward to working with you on this project and providing a long lasting asset that adds value and status to your property.

This estimation is valid for 14 days.

Yours Sincerely,



Barney Mclean  
Alpine Buildings NZ Ltd – **We Believe in Better.**